

# 180° LONG RADIUS RETURN BEND ANSI B16.9

## Buttweld, Class 200

90/10 Copper Nickel (UNS C70600)

70/30 Copper Nickel (UNS C71500)

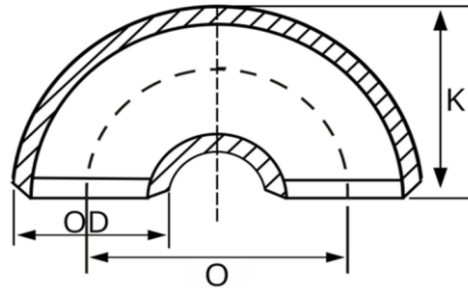

DIMENSIONS						
NOMINAL PIPE SIZE	OD	O	K	WEIGHT (lb)	TORK P/N 90/10	TORK P/N 70/30
1/2	0.84	3.00	1.88	0.10	<a href="#">Inquire</a>	<a href="#">Inquire</a>
3/4	1.05	3.00	2.00	0.20	<a href="#">Inquire</a>	<a href="#">Inquire</a>
1	1.32	3.00	2.19	0.40	<a href="#">M139990</a>	<a href="#">Inquire</a>
1 1/4	1.66	3.75	2.75	0.60	<a href="#">M139991</a>	<a href="#">Inquire</a>
1 1/2	1.90	4.50	3.25	0.90	<a href="#">M139992</a>	<a href="#">M140334</a>
2	2.38	6.00	4.19	1.50	<a href="#">M139993</a>	<a href="#">M140335</a>
2 1/2	2.88	7.50	5.19	2.50	<a href="#">M139994</a>	<a href="#">M140336</a>
3	3.50	9.00	6.25	4.00	<a href="#">M139995</a>	<a href="#">M140337</a>
3 1/2	4.00	10.50	7.25	6.50	<a href="#">M139996</a>	<a href="#">M140338</a>
4	4.50	12.00	8.25	10.00	<a href="#">M139997</a>	<a href="#">M140339</a>
5	5.56	15.00	10.31	18.00	<a href="#">M139998</a>	<a href="#">M140340</a>
6	6.63	18.00	12.31	30.00	<a href="#">M139999</a>	<a href="#">M140341</a>
8	8.63	24.00	16.31	54.00	<a href="#">M140000</a>	<a href="#">M140342</a>
10	10.75	30.00	20.38	106.00	<a href="#">M140001</a>	<a href="#">M140343</a>
12	12.75	36.00	24.38	192.00	<a href="#">M140002</a>	<a href="#">M140344</a>
14	14.00	42.00	28.00	240.00	<a href="#">Inquire</a>	<a href="#">Inquire</a>
16	16.00	48.00	32.00	314.00	<a href="#">Inquire</a>	<a href="#">Inquire</a>
18	18.00	54.00	36.00	394.00	<a href="#">Inquire</a>	<a href="#">Inquire</a>
20	20.00	60.00	40.00	486.00	<a href="#">Inquire</a>	<a href="#">Inquire</a>
22	22.00	66.00	44.00	588.00	<a href="#">Inquire</a>	<a href="#">Inquire</a>
24	24.00	72.00	48.00	698.00	<a href="#">Inquire</a>	<a href="#">Inquire</a>